



**Property Highlights**

5-mi. radius pop. 110,500  
 \$102,000 avg. HH income

**Out Parcels**

Outparcels Available  
 Starbucks  
 Bank of Oklahoma  
 Deaconess Medical Office  
 Carl's Jr.  
 Arby's  
 Hawthorn Suites

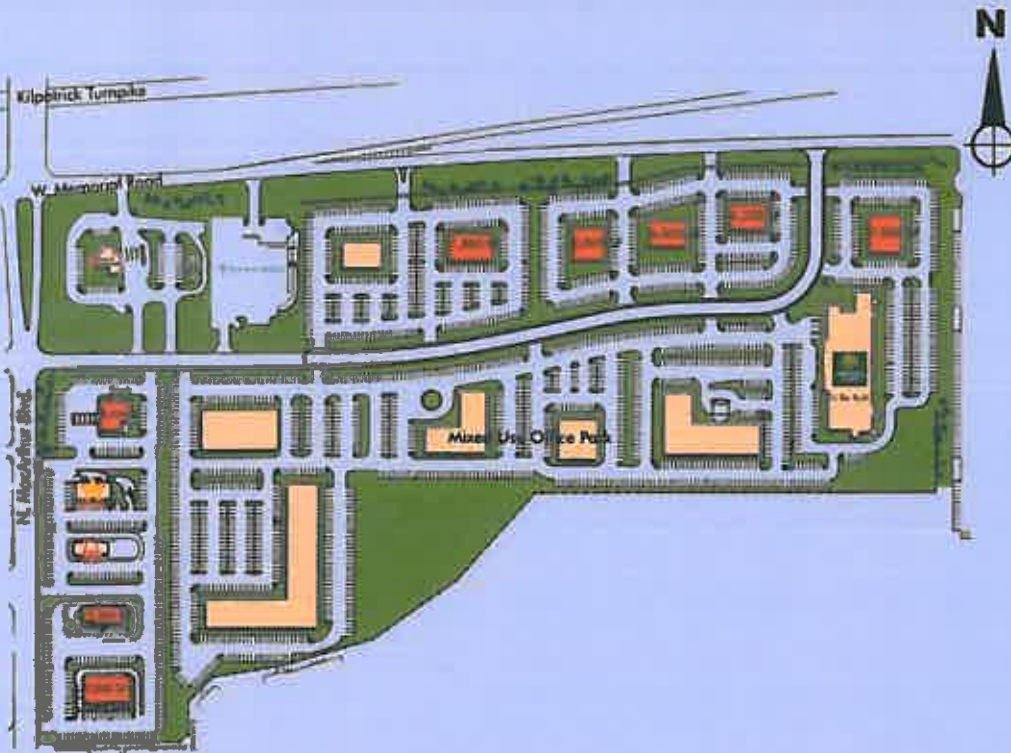

LOCATION

**MacArthur Crossing**  
 Oklahoma City, Oklahoma

**A Development Of**  
**HUNT PROPERTIES, INC.**



MacArthur

9/15/2009

Coordinates Longitude: -97.620730  
Latitude: 35.609860

	3.0 Mile Ring 28.27 sq/mi	5.0 Mile Ring 78.54 sq/mi	10.0 Mile Ring 314.16 sq/mi
<b>POPULATION</b>			
1990 Total Population	29,083	84,333	317,217
2000 Total Population	36,897	101,145	365,202
2008 Total Population	40,698	115,493	405,915
2013 Total Population	43,477	125,113	441,082
% Population Change 1990-2000	26.87%	19.94%	15.13%
% Population Change 2000-2008	10.30%	14.19%	11.15%
% Population Change 2008-2013	6.83%	8.33%	8.66%
<b>HOUSEHOLDS</b>			
1990 Total Households	11,548	35,952	130,980
2000 Total Households	15,659	44,380	152,871
2008 Total Households	18,035	52,232	175,195
2013 Total Households	19,320	56,372	187,111
% Households Change 1990-2000	35.60%	23.44%	16.71%
% Households Change 2000-2008	15.17%	17.69%	14.60%
% Households Change 2008-2013	7.13%	7.93%	6.80%
<b>2008 RACE</b>			
% 2008 White Population	81.76%	76.71%	74.79%
% 2008 Black Population	8.08%	12.88%	12.80%
% 2008 American Indian/Alaska Native	1.15%	1.19%	1.52%
% 2008 Asian/Hawaiian/Pacific Islander	5.05%	4.52%	4.39%
% 2008 Other Population (Incl 2+ Races)	3.97%	4.71%	6.50%
% 2008 Hispanic Population	4.31%	5.71%	8.27%
% 2008 Non-Hispanic Population	95.69%	94.29%	91.73%
<b>INCOME</b>			
2008 Per Capita Income	\$38,342	\$32,629	\$28,516
2008 Median Household Income	\$59,055	\$49,494	\$45,091
2008 Average Household Income	\$86,524	\$72,147	\$66,070
% 2008 Household Income < \$10,000	2.73%	3.72%	5.83%
% 2008 Household Income \$10,000-\$14,999	2.82%	4.13%	5.54%
% 2008 Household Income \$15,000-\$19,999	3.30%	5.10%	5.79%
% 2008 Household Income \$20,000-\$24,999	5.51%	6.41%	6.74%

MacArthur

9/15/2009

Coordinates Longitude: -97.620730  
Latitude: 35.609860

	3.0 Mile Ring 28.27 sq/mi	5.0 Mile Ring 78.54 sq/mi	10.0 Mile Ring 314.16 sq/mi
% 2008 Household Income \$25,000-\$29,999	4.12%	5.43%	6.02%
% 2008 Household Income \$30,000-\$34,999	5.35%	6.95%	7.02%
% 2008 Household Income \$35,000-\$39,999	5.76%	6.25%	6.35%
% 2008 Household Income \$40,000-\$44,999	5.12%	6.51%	6.59%
% 2008 Household Income \$45,000-\$49,999	4.92%	6.11%	6.43%
% 2008 Household Income \$50,000-\$59,999	11.45%	11.93%	12.11%
% 2008 Household Income \$60,000-\$74,999	13.32%	13.79%	12.12%
% 2008 Household Income \$75,000-\$99,999	19.40%	14.11%	11.11%
% 2008 Household Income \$100,000-\$124,999	6.70%	4.22%	3.72%
% 2008 Household Income \$125,000-\$149,999	4.68%	2.72%	1.93%
% 2008 Household Income \$150,000-\$199,999	1.96%	1.09%	1.05%
% 2008 Household Income \$200,000-\$249,999	0.65%	0.32%	0.60%
% 2008 Household Income \$250,000-\$499,999	2.12%	1.16%	1.01%
% 2008 Household Income \$500,000+	0.09%	0.04%	0.03%
2008 Average Household Size	2.2	2.2	2.3
% 2008 Total Owner Occupied Housing Units	66.49%	59.35%	62.42%
% 2008 Total Renter Occupied Housing Units	33.51%	40.65%	37.58%
2008 Total Daytime Population	34,369	102,798	393,266
2008 Total Daytime Work Population	16,844	49,912	193,606
2008 Total Establishments	1,902	4,999	21,282