



Property Highlights

5-mi. radius pop. 128,486
 \$52,052 avg. HH income



LOCATION



Earlywine Center
 Oklahoma City, Oklahoma

A Development Of
HUNT PROPERTIES, INC.

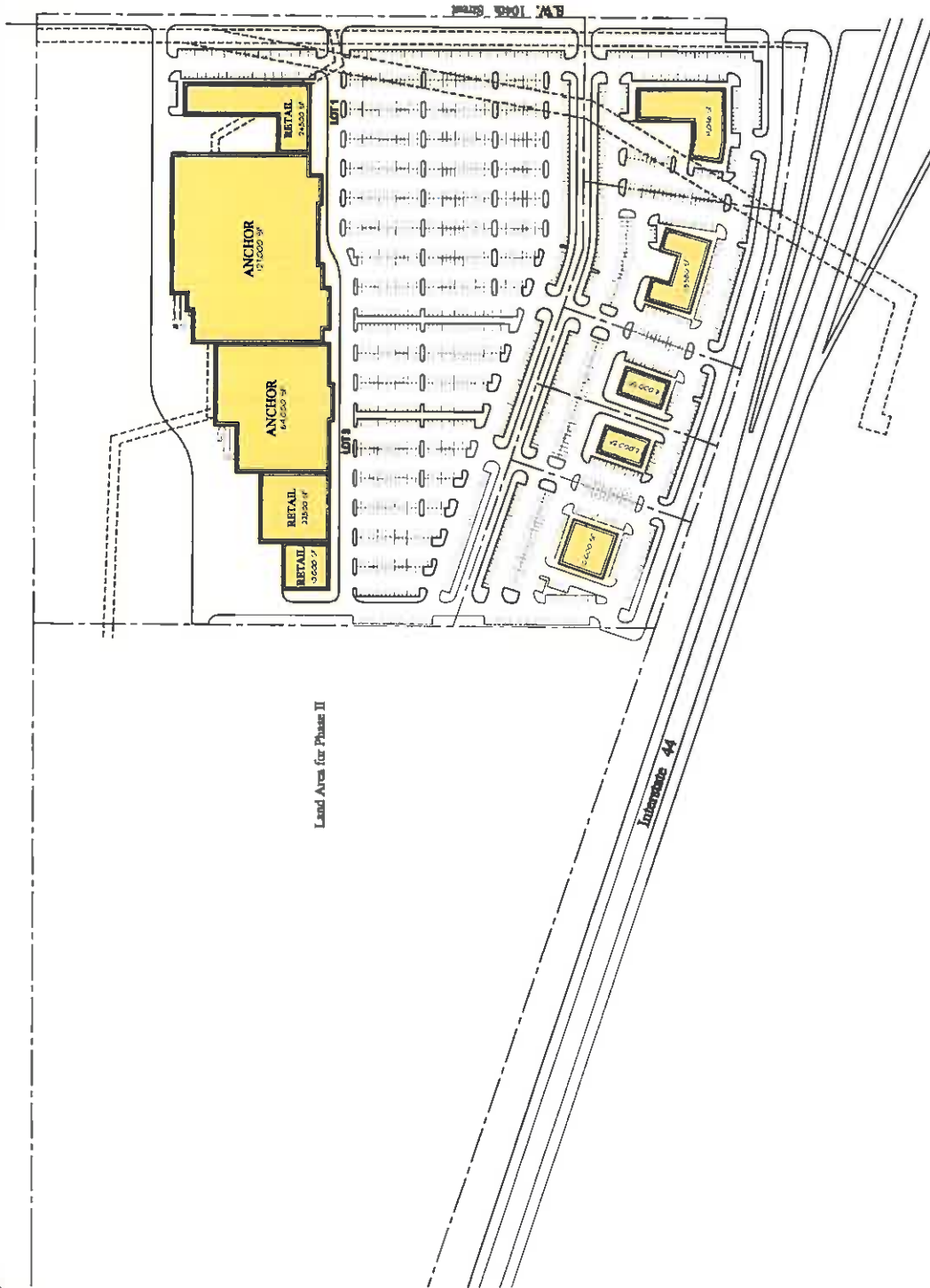

DATE PLOTTED

8/2/2010

Site Properties, Inc.



Concept Site Plan
 I-44 & S.W. 104th Street
 Oklahoma City, Oklahoma

CE
 ConceptSitePlan.com
 2508 Preston Road
 Suite 300-240
 Plano, Texas 75075
 Tel: 972.420.8888
 Fax: 972.420.8889
 www.CEDesignPlan.com

| | |
|-------------|------------|
| PROJECT NO. | 2009-036 |
| DATE | 03-18-2010 |
| SCALE | AS SHOWN |
| DRAWN BY | CH / LM |

SCALE
SP-1
 Conceptual Site Plan



1" = 100'-0"
 1/8" = 10'-0"
 1/4" = 20'-0"
 1/2" = 40'-0"
 3/4" = 60'-0"
 1" = 80'-0"
 1 1/4" = 100'-0"
 1 1/2" = 120'-0"
 1 3/4" = 140'-0"
 2" = 160'-0"
 2 1/4" = 180'-0"
 2 1/2" = 200'-0"
 2 3/4" = 220'-0"
 3" = 240'-0"

OKC-104th and I-44

9/15/2009

Coordinates Longitude: -97.580400
Latitude: 35.363070

| | 3.0 Mile Ring 28.27 sq/mi | 5.0 Mile Ring 78.54 sq/mi | 10.0 Mile Ring 314.16 sq/mi |
|---|---------------------------------|---------------------------------|-----------------------------------|
| POPULATION | | | |
| 1990 Total Population | 34,565 | 105,607 | 328,773 |
| 2000 Total Population | 42,048 | 117,752 | 364,652 |
| 2008 Total Population | 47,405 | 129,636 | 398,557 |
| 2013 Total Population | 51,831 | 138,116 | 426,635 |
| % Population Change 1990-2000 | 21.65% | 11.50% | 10.91% |
| % Population Change 2000-2008 | 12.74% | 10.09% | 9.30% |
| % Population Change 2008-2013 | 9.34% | 6.54% | 7.04% |
| HOUSEHOLDS | | | |
| 1990 Total Households | 12,950 | 40,903 | 126,624 |
| 2000 Total Households | 15,987 | 46,116 | 140,832 |
| 2008 Total Households | 18,924 | 52,842 | 159,079 |
| 2013 Total Households | 20,628 | 56,579 | 169,314 |
| % Households Change 1990-2000 | 23.45% | 12.74% | 11.22% |
| % Households Change 2000-2008 | 18.37% | 14.58% | 12.96% |
| % Households Change 2008-2013 | 9.00% | 7.07% | 6.43% |
| 2008 RACE | | | |
| % 2008 White Population | 78.89% | 76.66% | 70.92% |
| % 2008 Black Population | 6.16% | 5.64% | 10.28% |
| % 2008 American Indian/Alaska Native | 2.08% | 2.57% | 2.46% |
| % 2008 Asian/Hawaiian/Pacific Islander | 6.30% | 3.85% | 3.90% |
| % 2008 Other Population (Incl 2+ Races) | 6.58% | 11.28% | 12.44% |
| % 2008 Hispanic Population | 7.02% | 13.99% | 16.45% |
| % 2008 Non-Hispanic Population | 92.98% | 86.01% | 83.55% |
| INCOME | | | |
| 2008 Per Capita Income | \$25,673 | \$21,774 | \$20,767 |
| 2008 Median Household Income | \$48,420 | \$39,540 | \$37,602 |
| 2008 Average Household Income | \$64,312 | \$53,417 | \$52,030 |
| % 2008 Household Income < \$10,000 | 4.60% | 6.93% | 8.64% |
| % 2008 Household Income \$10,000-\$14,999 | 4.26% | 6.24% | 7.19% |
| % 2008 Household Income \$15,000-\$19,999 | 5.65% | 7.55% | 7.71% |
| % 2008 Household Income \$20,000-\$24,999 | 5.51% | 7.40% | 7.68% |

OKC-104th and I-44

9/15/2009

Coordinates Longitude: -97.580400
Latitude: 35.363070

| | 3.0 Mile Ring 28.27 sq/mi | 5.0 Mile Ring 78.54 sq/mi | 10.0 Mile Ring 314.16 sq/mi |
|--|---------------------------------|---------------------------------|-----------------------------------|
| % 2008 Household Income \$25,000-\$29,999 | 5.24% | 7.38% | 7.38% |
| % 2008 Household Income \$30,000-\$34,999 | 6.62% | 7.91% | 7.68% |
| % 2008 Household Income \$35,000-\$39,999 | 6.28% | 7.25% | 7.13% |
| % 2008 Household Income \$40,000-\$44,999 | 6.46% | 7.70% | 7.58% |
| % 2008 Household Income \$45,000-\$49,999 | 7.86% | 8.38% | 7.89% |
| % 2008 Household Income \$50,000-\$59,999 | 13.01% | 11.92% | 11.69% |
| % 2008 Household Income \$60,000-\$74,999 | 16.84% | 10.74% | 9.43% |
| % 2008 Household Income \$75,000-\$99,999 | 9.96% | 6.36% | 6.01% |
| % 2008 Household Income \$100,000-\$124,999 | 4.10% | 2.22% | 2.03% |
| % 2008 Household Income \$125,000-\$149,999 | 2.32% | 1.18% | 0.94% |
| % 2008 Household Income \$150,000-\$199,999 | 0.78% | 0.46% | 0.51% |
| % 2008 Household Income \$200,000-\$249,999 | 0.11% | 0.09% | 0.16% |
| % 2008 Household Income \$250,000-\$499,999 | 0.39% | 0.25% | 0.33% |
| % 2008 Household Income \$500,000+ | 0.01% | 0.01% | 0.01% |
| 2008 Average Household Size | 2.4 | 2.4 | 2.4 |
| % 2008 Total Owner Occupied Housing Units | 72.80% | 65.76% | 62.24% |
| % 2008 Total Renter Occupied Housing Units | 27.20% | 34.24% | 37.76% |
| 2008 Total Daytime Population | 39,501 | 110,576 | 393,338 |
| 2008 Total Daytime Work Population | 14,934 | 41,530 | 176,396 |
| 2008 Total Establishments | 1,591 | 4,516 | 17,926 |