



Property Highlights

250,000 SF retail
 104,000 trade area
 \$120,000 avg. HH income

Out Parcels

Out Parcels Available
 Bank of Oklahoma
 International Bank of
 Commerce
 Santa Fe Steakhouse



LOCATION



Bixby Centennial Plaza

Bixby, Oklahoma

 A Development Of
HUNT PROPERTIES, INC.

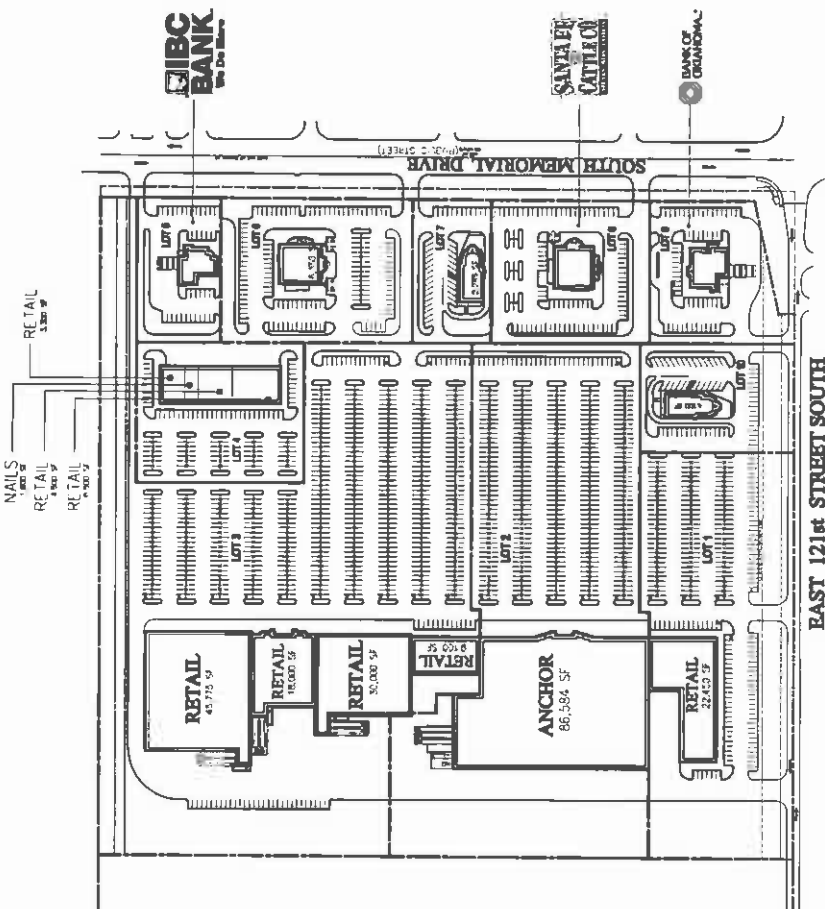

LOT	BLDG AREA SF	AREA SF	AREA ADJCD	PARK REQD	PARK PROVIDED
LOT 1	22,450	31,293	3,000	118	330
LOT 2	8,384	54,493	8,285	435	48
LOT 3	6,275	240,744	3,351	314	730
LOT 4	8,000	24,848	144	8	115
LOT 5	4,500	43,269	190	10	36
LOT 6	6,250	14,741	2,24	64	54
LOT 7	2,225	40,888	0.15	15	35
LOT 8	12,000	5,464	9.1	12	24
LOT 9	3,900	83.8	1.65	25	35
LOT 10	4,500	80,764	134	40	36
TOTAL	550,285 SF	1,857,482 SF	37,47 AG		

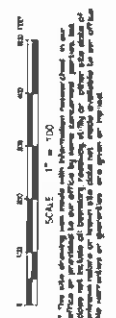

This site plan is prepared for use only in connection with the project for which it is prepared. It is not to be used for any other purpose without the written consent of the architect. The architect assumes no responsibility for the accuracy of the information shown hereon or for the results of any construction based thereon.

Bixby Centennial Plaza
 Bixby, Oklahoma
 Hunt Properties, Inc.

<p>Hunt Properties, Inc. 2200 Douglas Ave. Suite 1000 Bixby, Oklahoma 75008 Tel: 918.223.1111 Fax: 918.223.1111</p>	<p>CE Design/Plan www.CEDesignPlan.com</p>	<p>SP-27</p> <p>Comprehensive Site Plan</p>
<p>DATE: 05/07/2023</p> <p>SCALE: 1/8" = 1'-0"</p>	<p>PROJECT NO: 2023-021</p> <p>OWNER BY: 12/1/14</p>	<p>DATE: 05/07/2023</p> <p>SCALE: 1/8" = 1'-0"</p>

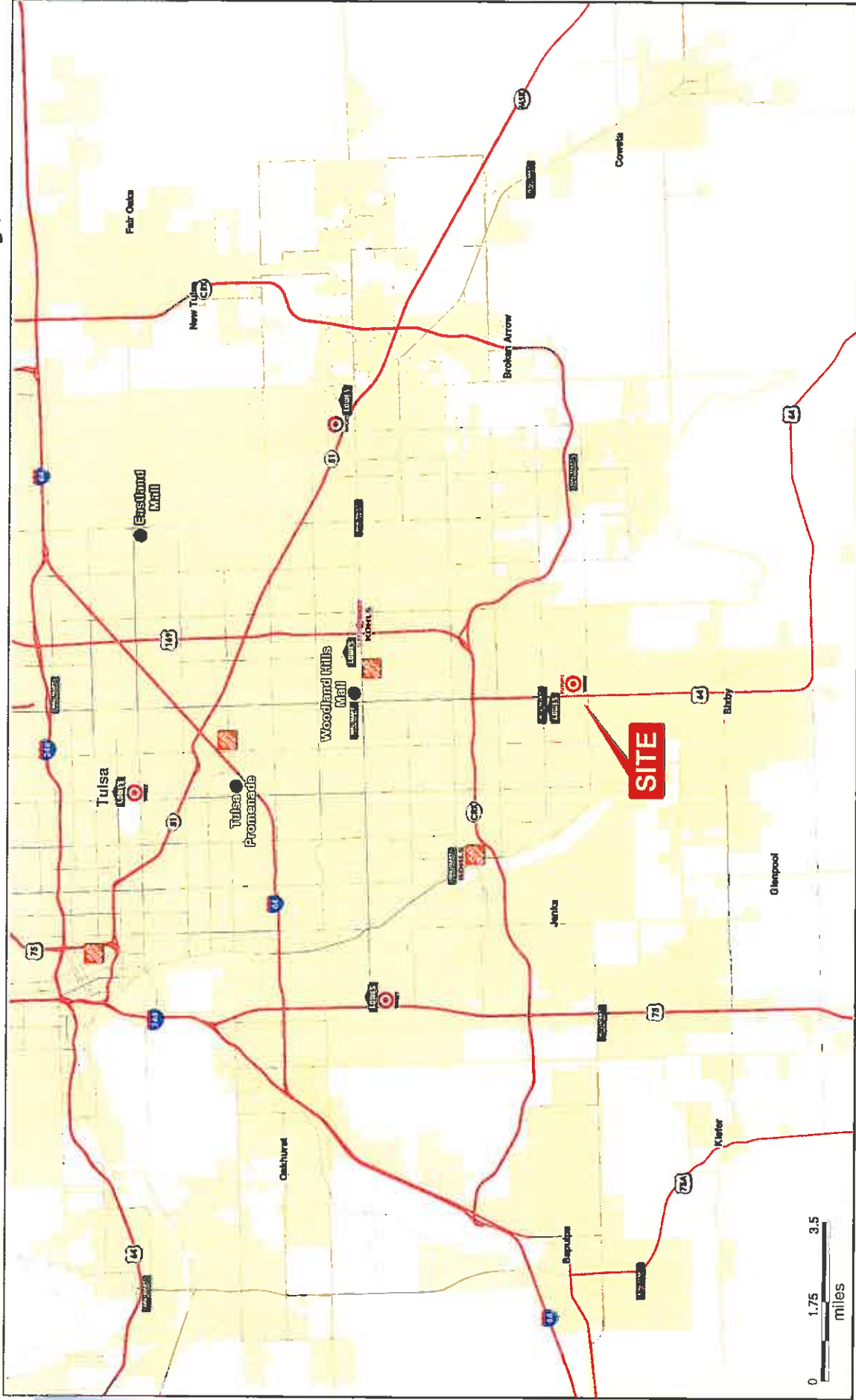



Bixby Centennial Plaza

9/15/2009

Coordinates Longitude: -95.886510
Latitude: 35.988320

	3.0 Mile Ring 28.27 sq/mi	5.0 Mile Ring 78.54 sq/mi	10.0 Mile Ring 314.16 sq/mi
POPULATION			
1990 Total Population	17,255	65,755	286,441
2000 Total Population	29,044	93,546	331,922
2008 Total Population	36,218	110,644	357,398
2013 Total Population	40,304	121,610	377,173
% Population Change 1990-2000	68.32%	42.26%	15.88%
% Population Change 2000-2008	24.70%	18.28%	7.68%
% Population Change 2008-2013	11.28%	9.91%	5.53%
HOUSEHOLDS			
1990 Total Households	6,109	24,156	115,179
2000 Total Households	10,279	34,965	134,356
2008 Total Households	13,406	43,384	151,302
2013 Total Households	15,067	47,903	160,175
% Households Change 1990-2000	68.26%	44.75%	16.65%
% Households Change 2000-2008	30.42%	24.08%	12.61%
% Households Change 2008-2013	12.39%	10.42%	5.86%
2008 RACE			
% 2008 White Population	89.44%	87.44%	81.11%
% 2008 Black Population	2.04%	3.44%	6.88%
% 2008 American Indian/Alaska Native	1.97%	1.93%	2.47%
% 2008 Asian/Hawaiian/Pacific Islander	2.42%	2.55%	2.48%
% 2008 Other Population (Incl 2+ Races)	4.13%	4.64%	7.07%
% 2008 Hispanic Population	4.30%	5.35%	8.20%
% 2008 Non-Hispanic Population	95.70%	94.65%	91.80%
INCOME			
2008 Per Capita Income	\$38,193	\$35,373	\$29,486
2008 Median Household Income	\$67,767	\$61,618	\$47,600
2008 Average Household Income	\$103,184	\$90,214	\$69,649
% 2008 Household Income < \$10,000	2.12%	2.50%	4.50%
% 2008 Household Income \$10,000-\$14,999	1.54%	2.45%	4.98%
% 2008 Household Income \$15,000-\$19,999	2.72%	3.53%	5.52%
% 2008 Household Income \$20,000-\$24,999	2.25%	2.96%	6.08%

Bixby Centennial Plaza

9/15/2009

Coordinates Longitude: -95.886510
Latitude: 35.988320

	3.0 Mile Ring 28.27 sq/mi	5.0 Mile Ring 78.54 sq/mi	10.0 Mile Ring 314.16 sq/mi
% 2008 Household Income \$25,000-\$29,999	2.33%	3.97%	5.82%
% 2008 Household Income \$30,000-\$34,999	3.54%	4.02%	6.17%
% 2008 Household Income \$35,000-\$39,999	4.76%	4.72%	6.54%
% 2008 Household Income \$40,000-\$44,999	4.75%	5.33%	6.79%
% 2008 Household Income \$45,000-\$49,999	5.01%	6.11%	6.92%
% 2008 Household Income \$50,000-\$59,999	13.29%	12.77%	12.28%
% 2008 Household Income \$60,000-\$74,999	14.85%	15.26%	12.54%
% 2008 Household Income \$75,000-\$99,999	18.33%	18.80%	12.13%
% 2008 Household Income \$100,000-\$124,999	8.80%	7.38%	4.43%
% 2008 Household Income \$125,000-\$149,999	5.87%	4.79%	2.39%
% 2008 Household Income \$150,000-\$199,999	4.95%	2.84%	1.53%
% 2008 Household Income \$200,000-\$249,999	1.93%	0.86%	0.46%
% 2008 Household Income \$250,000-\$499,999	2.90%	1.67%	0.89%
% 2008 Household Income \$500,000+	0.06%	0.03%	0.02%
2008 Average Household Size	2.7	2.5	2.3
% 2008 Total Owner Occupied Housing Units	82.12%	73.81%	63.02%
% 2008 Total Renter Occupied Housing Units	17.88%	26.19%	36.98%
2008 Total Daytime Population	29,664	90,990	345,947
2008 Total Daytime Work Population	11,952	39,430	179,619
2008 Total Establishments	1,551	4,409	18,698